

Person Submitting Cross Section _____

Job Address _____

Date: _____

Engineered Truss System Yes No

Roof Slope _____

Headers shall be labeled on the floor plan or roof framing plan

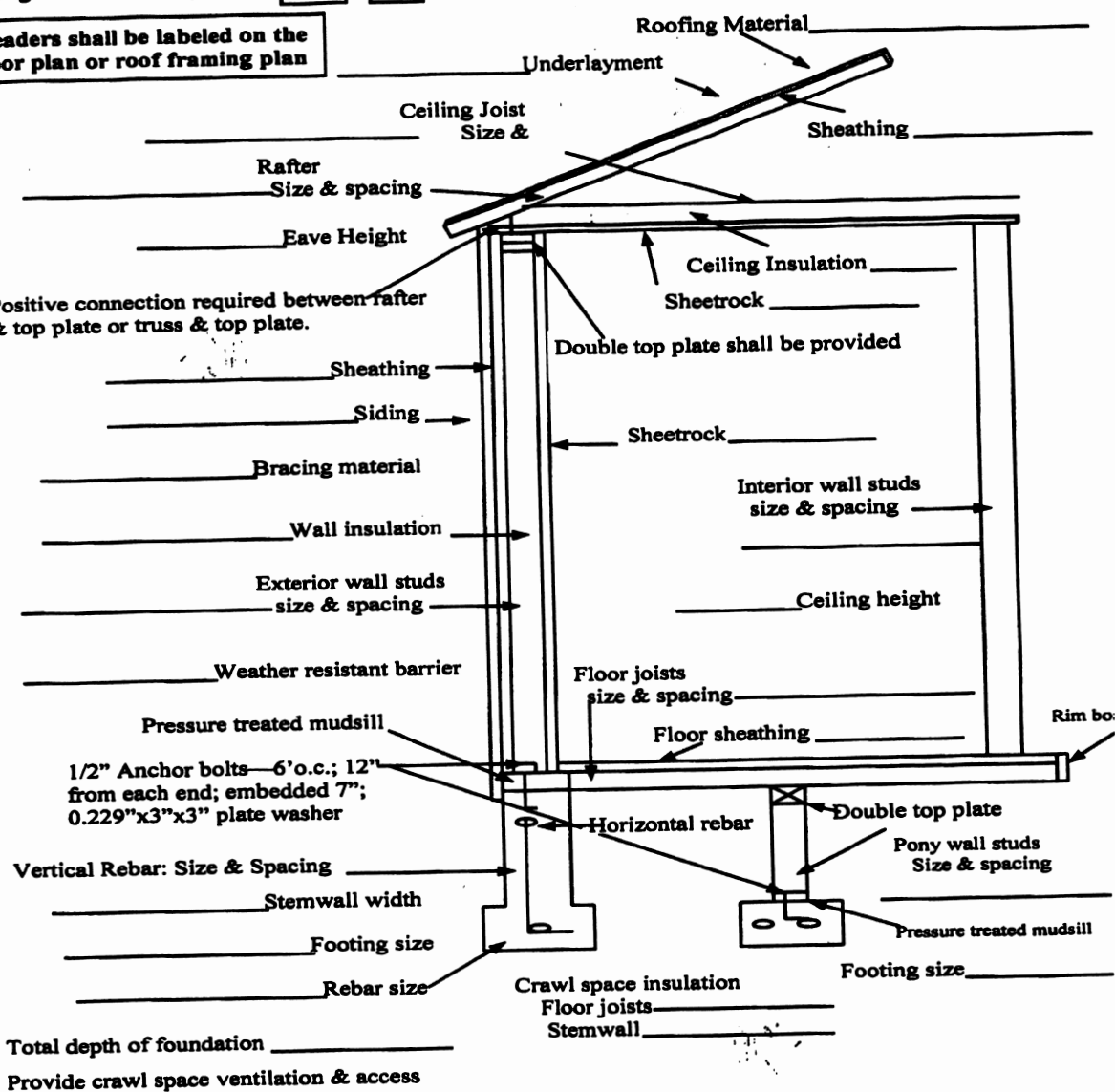

Total depth of foundation _____

Provide crawl space ventilation & access

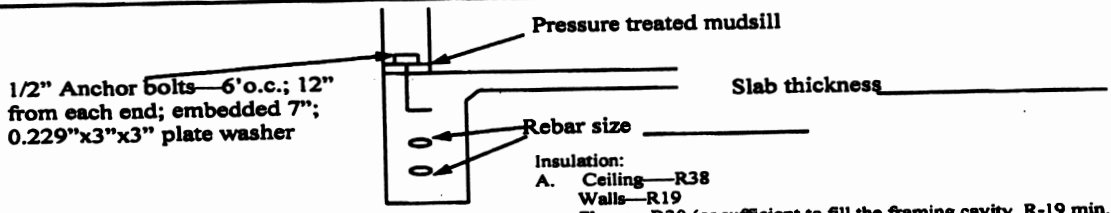

Footing width _____

Total depth of foundation _____

- Insulation:
- A. Ceiling—R38
 - Walls—R19
 - Floors—R30 (or sufficient to fill the framing cavity, R-19 min.)
 - Basement walls—R10
 - Crawl Space walls—R10
 - B. Stemwall insulation—Do not install under floor vents. See other specific requirements
 - C. Floor insulation—install under floor vents. Wrap all ducts and water lines below the insulation.